

## Mp Filtri

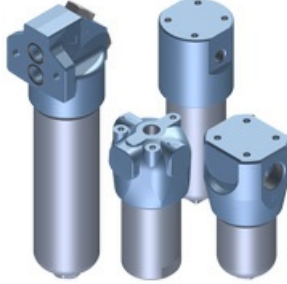

Garanti: 12 ay

Bu rne ait Trkiye ii kapı teslim fiyat ve teslim sresi ieren teklifimizi almak iin [info@yursat.com.tr](mailto:info@yursat.com.tr) e-posta adresine baŐvuru yapabilir ya da ayrıntılı bilgi iin +90 224 240 03 04 numaralı telefonumuzdan bizlere ulaŐabilirsiniz.

**Mp Filtri** Markası, tedarik sresi iin ltfen bizimle iletiŐime geiniz.

*Firmamız Mp Filtri Trkiye Distribtr veya temsilcisi deĐildir. Firmamız sipariŐ durumunda, belirtilen rnlerde sadece Orjinal ve yeni rn teklifi sunmaktadır. Bu sitede gsterilen zel marka adları ve ticari markalar ilgili sahiplerinin mlkiyetindedir, talep durumunda kaldırılmaktadır.*

rn	Aıklama
<a href="#">Mr2503m25a P01</a>	
<a href="#">Cu2101a10anp01</a>	CU2101A10ANP01
<a href="#">Mf1003a25hbp01</a>	
<a href="#">8hp0652a10anp01</a>	
<a href="#">8hp0651a10anp01</a>	
<a href="#">8hp0653a10anp01</a>	
<a href="#">Fmp1352bag2a10np01</a>	FMP1352BAG2A10NP01 Complete filter, glass fiber 10µm PLEASE CHECK THE NAME REQUESTED (Filter is without clogging indicator or Plug "T2V" (item 2) included
<a href="#">8hp1352a10anp01</a>	HP1352A10ANP01 Referenz: 1731
<a href="#">Mf4002p25nbp01</a>	
<a href="#">Mf4003a25hbp01</a>	Gewicht/Stk: 1,24000 Zolltarifnummer: 84212980
<a href="#">Mr2504a10ap01</a>	Brand : MP FİLTRİ SİZE : D1=105 D2=71 H=462
<a href="#">MF1003A25HBP01</a>	Filterelement
<a href="#">SF510M90</a>	8SF510M90
<a href="#">8CU250A25N</a>	CU250A25N Referenz: 1184
<a href="#">CS100A25A</a>	8CS100A25A
<a href="#">CS-100-P25-A</a>	
<a href="#">MF1801P25NBP01</a>	
<a href="#">Element no:MF0301P25NB</a>	

<a href="#">FMP0652-BAG2P001</a>	
<a href="#">HP1352A10ANP01</a>	8HP1352A10ANP01 P01 = MP Filtri Standardversion (mit MP Logo)
<a href="#">CU-350-A25-N</a>	
<a href="#">MF4003A10HBP01</a>	
<a href="#">CU2103A06ANP01</a>	
<a href="#">CU9503A06ANP01</a>	
<a href="#">ZH224068 hydraulic filter</a>	
<a href="#">CU1102M60ANP01</a>	
<a href="#">MF1001A10HBP01</a>	8MF1001A10HBP01
<a href="#">MPF-100-1-A-G2-A10-H-B-P01</a>	MPF1001AG2A10HBP01
<a href="#">MPA220G1M90 2" BSP</a>	
<a href="#">MPA220G1M90 2" BSP</a>	
<a href="#">MPF1001AG2A25HBP01</a>	
<a href="#">8CU1102A06ANP01</a>	
<a href="#">MR2504A06AP01</a>	
<a href="#">8CU350A10N</a>	
<a href="#">8MR1004A06A</a>	
<a href="#">8HP0394A06ANP01</a>	
<a href="#">CH-070-A25-A</a>	Filterelement
<a href="#">EGE-6</a>	sprocket
<a href="#">EGE-3</a>	sprocket
<a href="#">SAP-054-G1L-10A--P01</a>	SAP054G1L10A
<a href="#">FHB3202BAF1A10NP01</a>	FHB3202BAF1A10NP01 Weight/pc: 15.60000
<a href="#">DLA50VA51P01</a>	24 V, reed contact replaces KR71VP01 Weight/pc: 0.16000
<a href="#">FMP0653SAG2A03HP01</a>	FMP0653SAG2A03HP01
<a href="#">DLA70VA51P01</a>	DLA70VA51P01 24 V, reed contact replaces KR81VP01
<a href="#">8HP0653A03AHP01</a>	HP0653A03AHP01
<a href="#">MF10002A25HBP01</a>	MFG: 17OP006119
<a href="#">MF1003A16HBEP01</a>	filter element Microfiber 16µm NBR seal Bypass valve 3bar opening pressure Weight: 0.8kg Customs tariff number: 84212980

<a href="#">FHB0651DAF1A10NP01</a>	FHB065-1DAF1/A10N/P01
<a href="#">HP1352A10ANP01</a>	8HP1352A10ANP01
<a href="#">8HP1352A10AHP01</a>	
<a href="#">8HP0501A10ANP01</a>	
<a href="#">MPF-100-2-A-G2-A25-H-B-P01</a>	return filter
<a href="#">MF-100-2-A25-H-B-P01</a>	filter element
<a href="#">MPF 1003AG2A25HBP01</a>	
<a href="#">8MF 1003A25HBP01</a>	
<a href="#">MF4002P25NBP01</a>	8MF4002P25NBP01 Referenz: 2087
<a href="#">FRI250BAG1A10N</a>	FRI250BAG1A10NP01 Referenz: 20163
<a href="#">FRI040BAG1M25N</a>	FRI040BAG1M25NP01 Referenz: 20837
<a href="#">DVA20VP01 (Optional)</a>	DVA20VP01 OPT. 2.0 BAR replaces V6
<a href="#">MP Filtri CS 050 A10 A</a>	
<a href="#">MP Filtri HP-039-2-A25-A-N-P01</a>	
<a href="#">8CU100A06N</a>	CU100A06N
<a href="#">8CH150P25A</a>	1071 CH-150-P25-A
<a href="#">CS-050-A10-A</a>	
<a href="#">HP-039-2-A25-A-N-P01</a>	8HP0392A25ANP01 1642
<a href="#">8CU1101M60ANP01</a>	CU1101M60ANP01
<a href="#">8HP0652A25AHP01</a>	
<a href="#">3500-SY-MP 11 filter</a>	PP filter with pretreatment chamber, 47 pieces of 295/64 mm filter disc, filtering surface 3.1 m2, Waste holding capacity 12 L. Capacity 15 m3/h, Input/Output: d50/d40 PP Magnetic pump (max. Pump Cap. 18 m) 3/h, max. P: 18 meters). Motor 1.5 kW/400V/3PH.
<a href="#">MPF 4600-PP-SY-MP12/B5-POF filter</a>	PP filter with pretreatment chamber, 41 filter discs of 350/60 mm, filtering surface of 3.8 m2, Waste holding capacity 24 L. Capacity 23 m3/h, Input/Output: d63/d50 PP Magnetic pump (max. Pump Cap.30 m3/h, max. P: 22 m). Engine 2.2 kW/400V/3PH.
<a href="#">CS050P25A</a>	FILTER ELEMENT \ INNER DIAMETER: 24 MM \ OUTER DIAMETER: 95 MM \ LENGTH: 185 MM
<a href="#">EGE 5 SGEA51</a>	
<a href="#">HP3204A10VSP01</a>	

<a href="#">HC3310 FGS 40 H</a>	
<a href="#">HC9600FKS8H</a>	
<a href="#">1POG20FNS025G</a>	
<a href="#">SGEA21M05055</a>	
<a href="#">FHP1352BAG2A10NP01</a>	FHP-135-2-B-A-G2-A10-N-P01
<a href="#">HP1352A10ANP01</a>	HP-135-2-A10-A-N-P01
<a href="#">HP-135-2-A10-A-N-P01</a>	ELEM.FILT. HP 135-2-A10-AN 8HP1352A10ANP01
<a href="#">DL-E-50-V-A-50-P01</a>	STOPPAGE INDICATOR DLE50VA50P01 DLE50VA50P01
<a href="#">MF4003A10HBP01</a>	
<a href="#">HP3203A10ANP01</a>	
<a href="#">MF7501A10HBP01</a>	
<a href="#">MPF1002AG3A25HBP01</a>	
<a href="#">HP-065-1-A10-A-N-P01</a>	
<a href="#">MPF1003AG3P25NBP01</a>	MPF1003AG3P25NBP01 Komplet
<a href="#">8MF1003P25NBP01</a>	MF1003P25NBP01 Replacement filter element
<a href="#">HP-065-1-A10-A-N-P01</a>	8HP0651A10ANP01
<a href="#">MF1001A10HBP01</a>	OIL FILTER
<a href="#">8MF1002P25NBP01</a>	MF1002P25NBP01
<a href="#">pressure switch</a>	
<a href="#">8HP0651A10ANP01</a>	HP-065-1-A10-A-N-P01
<a href="#">MF1002A25HBP01</a>	ELEM.FILTR.MICROFIBRA MICROFIBRE FILTER ELEMENT
<a href="#">HP0503A10ANP01</a>	ELEM.FILTR.MICROFIBRA MICROFIBRE FILTER ELEMENT
<a href="#">HP-050-3-A10-A-N-P01</a>	8HP0503A10ANP01
<a href="#">HP-150-3-A10-A-N-P01</a>	8HP1503A10ANP01
<a href="#">FF200336B</a>	
<a href="#">FRI250BAG1A10N</a>	RETURN FILTER
<a href="#">DVA20VP01</a>	VISUAL INDICATOR EX V6
<a href="#">FRI040BAG1M25N</a>	RETURN FILTER
<a href="#">DVA20VP01</a>	VISUAL INDICATOR EX V6
<a href="#">8HP1352A03ANP01</a>	HP1352A03ANP01
<a href="#">8HP0653A06ANP01</a>	HP0653A06ANP01

<a href="#">20774</a>	BE-A-15-HA-50-P01 changeover 1.5 bar
<a href="#">Cu100m60</a>	
<a href="#">Lvu1500pa10p01 Level Indicator</a>	
<a href="#">Gup-P-003</a>	
<a href="#">Lmp-400-2-B-A-G2-A10-N-P01+t2</a>	
<a href="#">Lmp-401-5-B-A-G1-Xxx-P01</a>	
<a href="#">Msh050svg1a10</a>	
<a href="#">135-/2/A03</a>	
<a href="#">Hp1351a25ahp01 Filter-Element</a>	
<a href="#">Str0502sg1m90p01 Hydraulic Power Transmission Spindle Cnc Machine Tools</a>	
<a href="#">Fhb-065-2-B-A-F1-Xxx-P01</a>	
<a href="#">Lmp-400-4-B-V-F2-Xxx-P01</a>	
<a href="#">Fhb-320-1-S-A-F1-A10-H-P01</a>	
<a href="#">Hp0652a10h</a>	
<a href="#">Lmp-400-2-B-V-G1-Xxx-P01</a>	
<a href="#">300094 Filterelementtefb 70.25vg</a>	
<a href="#">Hf3202a10an</a>	
<a href="#">Mf1801m25nbp01</a>	
<a href="#">Lmp-400-2-B-A-G1-M60-N-P01+t2</a>	
<a href="#">Ege6</a>	
<a href="#">Sf-510-M90-N-P01 Filter</a>	
<a href="#">Mf1003a25hb Filter</a>	
<a href="#">Lmp-430-5-B-A-F1-A10-N-P01+s</a>	
<a href="#">Hp3204a25an Filterelement</a>	
<a href="#">Lmp-400-3-S-A-G1-Xxx-P01</a>	
<a href="#">Mfg005942</a>	
<a href="#">2501a1afs</a>	
<a href="#">Mf7501a10hbp01 Filterelement</a>	
<a href="#">Filterelement Mf 0201a25hbep01</a>	
<a href="#">Lmp-950-3-S-A-F1-Xxx-P01</a>	

<a href="#">Cu250a10n Filterelement</a>
<a href="#">Cu4005a10anp01</a>
<a href="#">Cu2101m25anp01</a>
<a href="#">Cs150a06a Patronen-Filterelement</a>
<a href="#">Cu100p10n Filter</a>
<a href="#">8mf400-3a25hb</a>
<a href="#">Lmp-900-2-B-A-F1-A25-N-P01+t2</a>
<a href="#">Hp1352a03anp01</a>
<a href="#">Fhb-065-1-B-V-F1-Xxx-P01</a>
<a href="#">Fhb-050-5-B-A-F1-Xxx-P01</a>
<a href="#">Lva10tapm10s01</a>
<a href="#">Mp Hp 065 3 M60 An</a>
<a href="#">Lva30sapm12-S01</a>
<a href="#">Hp0501a10anp01</a>
<a href="#">Mps-050-R-G2-A10-A-Vr</a>
<a href="#">Filterelementhp-065-3-A10-A-N-P01</a>
<a href="#">Esa.21.B04.W.M.F 070/1 S M090 G1 1.2</a> <a href="#">Hydraulikfilter (Mmc 80)</a>
<a href="#">Str0866sg1m90p01 Filter</a>
<a href="#">50m250ag</a>
<a href="#">Str070-4-Sg1-M60</a>
<a href="#">Hp0392a25an Filterelementalte Nr.</a> <a href="#">Hp0371a25an</a>
<a href="#">?Pf-400-3-A-G1-P10-N-B-P01+ew-15</a> <a href="#">Filter</a>
<a href="#">Sgea2100?050</a>
<a href="#">Lmc200mfs1004e Lmc200mfs1004e</a>
<a href="#">Hp1351a25ah Der Backbone- Filter/Element</a>
<a href="#">Lmc160mfs1004s Glocke</a>
<a href="#">2170 Mpa012g1m90</a>
<a href="#">Sf-503-M90-N-P01 Filter</a>

<a href="#">Ch150a10a</a>
<a href="#">Lmp-400-2-B-A-F1-Xxx-P01</a>
<a href="#">Elastischer Element Ege 5 Rp</a>
<a href="#">Lmp-400-5-B-A-G2-A10-N-P02+t2</a>
<a href="#">Sa115g1l10a</a>
<a href="#">Fhp-135-2-B-A-G5-Xxx-P01</a>
<a href="#">Cu025m90n Filterelement</a>
<a href="#">Fmm0503bhda10np03</a>
<a href="#">Lmp1102sab2m25np01 Filter</a>
<a href="#">Fhp-135-2-B-V-G5-A10-N-P01</a>
<a href="#">Hp3202a25an Filterelement</a>
<a href="#">Sp-Cfe 250/25</a>
<a href="#">Fhp-135-2-S-V-F1-M60-N-P01</a>
<a href="#">Fmp0392saa6a06np01</a>
<a href="#">Fhp-135-2-B-A-G1-Xxx-P01</a>
<a href="#">Mph1163cdsag2a25p01+bea14ha50p01 Drain Filter With Indicator.</a>
<a href="#">Glocke Monoblock-Lmc 200 M Fs200 4s- P00, "mp Filtri"</a>
<a href="#">Sf 540m250np01 Filterelement</a>
<a href="#">Cs150p10a</a>
<a href="#">Cu 630 A25n</a>
<a href="#">Lmp-951-2-B-A-F1-Xxx-P01</a>
<a href="#">Adnema364tc</a>
<a href="#">Lva30tvpm12s01</a>
<a href="#">Dex50va50p01 Filter</a>
<a href="#">Mf 180 1 P25 Nb</a>
<a href="#">Lmp-430-5-B-A-G1-Xxx-P01</a>
<a href="#">?H-050-P25-A Filter</a>
<a href="#">Lms-250-A-Fsa-003</a>
<a href="#">Lmp-950-3-B-A-F3-A25-N-P01</a>

<a href="#">Fhb-065-1-S-A-F1-Xxx-P01</a>	
<a href="#">Lva30tapm12s01 Level Indicator</a>	
<a href="#">Cu250m60n</a>	
<a href="#">Fx15 125vac-3a/110vdc-0,15a</a>	
<a href="#">Ege3rr</a>	
<a href="#">Mp10405010</a>	
<a href="#">Hp0653?10?Np01</a>	
<a href="#">8mf1802a16hbep01 Filterelement</a>	
<a href="#">Cu 100 M25 N Filter</a>	
<a href="#">030061</a>	
<a href="#">Cs150a10a Filter</a>	
<a href="#">A11110 Filterelement</a>	
<a href="#">Str100-4-S-G1-M90-P01 Mp Filtri Filter</a>	
<a href="#">Lmc206afrc070</a>	
<a href="#">Hp3202m250anp01</a>	
<a href="#">Lva30-T-Apm12s01</a>	
<a href="#">Mf4002m25nb Filtroelement</a>	
<a href="#">Hp03202a10anp01</a>	
<a href="#">Lvk30am122t7p01-Tv12 Level Sensor 286mm</a>	
<a href="#">Lmp-400-5-S-A-F1-Xxx-P01</a>	
<a href="#">Lmc250mfs1004s Glocke</a>	
<a href="#">Mf0301p10nb Filterelement</a>	
<a href="#">Lmp-401-4-B-A-G2-Xxx-P01</a>	
<a href="#">Lmp-430-6-B-A-G2-Xxx-P01</a>	
<a href="#">Lpa2-W-M-S-X-30-Eu</a>	
<a href="#">Fhb-065-1-B-A-F1-A25-N-P01</a>	
<a href="#">Lmp2101sag3p01</a>	LMP2101SAG3XXXP01 + T2 filter housing
<a href="#">Lva20tvpm12s01</a>	FKM version Special net price for 100 pieces
<a href="#">Cu630a10n</a>	
<a href="#">Filter Saug-Str 086-3 B G1 M60 P01, "mp Filtri"</a>	



<a href="#">Cu2103m90anp01 Filtrelement</a>
<a href="#">Mf4003a10hbp01</a>
<a href="#">34082</a>
<a href="#">Ege2</a>
<a href="#">Ege8</a>
<a href="#">Schalter Manometer Svm-3g A P01, "mp Filtri"</a>
<a href="#">8cs050p10a</a>
<a href="#">Sp-Pf-102/A25</a>
<a href="#">Fmp-039-2-B-A-A-6-Xxx-X-P01 Filtrelement</a>
<a href="#">Hp1352a25anp01 Filtrelement</a>
<a href="#">Hp1352a10anp01 Filtrelement</a>
<a href="#">1057 8ch050m60a</a>
<a href="#">Lmp-951-2-B-A-F1-A10-N-P01</a>
<a href="#">Mpf1811ag1a10hbv1p01</a>
<a href="#">Dichtung Gum P 200, "mp Filtri"</a>
<a href="#">Sm16g50a</a>
<a href="#">Fhb-065-2-S-A-F1-A10-H-P01</a>
<a href="#">Mf1003a10 Hbp01 Filter</a>
<a href="#">Fhp-135-2-B-A-G2-Xxx-P01</a>
<a href="#">Cs-150-A10-A Filter</a>
<a href="#">Hp1351a10anp01</a>
<a href="#">Str-140-2-S-G1-M90-P01</a>
<a href="#">Sa145g1l40a</a>
<a href="#">Lms-250-M-Fszfr-4s</a>
<a href="#">Ta80bo3b001p01 Hydraulikfilter Sapun (Mmc 80)</a>
<a href="#">Filtrelementmf-180-1-A25-H-B-P01</a>
<a href="#">Mf-100-3-P10-Nb Filter-Kartusche</a>
<a href="#">8mf1801a25hbep01</a>

<a href="#">Hp3202a10ah</a>
<a href="#">Hp-020-1-A25-V-H</a>
<a href="#">Lmp-900-1-S-A-F1-Xxx-P01</a>
<a href="#">Lmp-400-5-S-A-G2-Xxx-P01</a>
<a href="#">Mph 250 1edsag2 A10 P01 Filter</a>
<a href="#">Cu250m125</a>
<a href="#">Filterelement Cs050a10a</a>
<a href="#">Fmp 038 1 B A G1 A03 N P01 K71 G1/2 Filter</a>
<a href="#">Hp0651a10anp01</a>
<a href="#">Hp3203a10h</a>
<a href="#">10-A03-A-H-P01</a>
<a href="#">Str 100-1 B G2 M90</a>
<a href="#">Mf1001a25hbp01 Filterelement</a>
<a href="#">Hp1351a06vup01 Filter</a>
<a href="#">Lmp-400-5-S-A-G1-Xxx-P01</a>
<a href="#">Mf1001p10nbp01</a>
<a href="#">Lmp-900-1-B-A-F1-A10-N-P01</a>
<a href="#">Mf4002a10hb Filter</a>
<a href="#">Fx15 Indicator</a>
<a href="#">Cs150a25a Filterelement</a>
<a href="#">Mf1801p25nbp01 Filterelement</a>
<a href="#">Hp1352a25ahp01 Filterelement</a>
<a href="#">8a10I40</a>
<a href="#">Mpf-180-1-A-G1-P25-N-B-Er</a>
<a href="#">Fmp0392baa2m25np01 Filter</a>
<a href="#">Cs-150-A10-A</a>
<a href="#">Fhp-135-2-S-V-F1-Xxx-P01</a>
<a href="#">Mf0202p10nbp01</a>
<a href="#">Mf1002p025nbp01</a>
<a href="#">Lmp-400-6-B-A-F1-A25-N-P01+t2</a>

<a href="#">Filterelement Hp 0501a25anp01</a>
<a href="#">Fhp-135-2-B-A-F1-Xxx-P01</a>
<a href="#">Mf1002a25hbp01 Filterelement</a>
<a href="#">Cu1102m90hnp01 Filter</a>
<a href="#">Cs050m90a Filterelement</a>
<a href="#">Mf1001p025nbp01 Mp Filtrfiltr</a>
<a href="#">Hp0394m60vnp01 Filter Element</a>
<a href="#">Indikator Der Verschmutzung Dla 70has1 P01, "mp Filtri"</a>
<a href="#">Hp0652a25an Filtroelementmineral Oil Sealed</a>
<a href="#">Sap 115 Luftfilter (Cartridge)</a>
<a href="#">Hp1353a10an</a>
<a href="#">Lmp-400-2-B-A-G1-M25-N-P01+t2</a>
<a href="#">Mf-400-2-A10-H-B-P01</a>
<a href="#">Cu630m60n Hydraulikfilter (Metall)</a>
<a href="#">Hp3202a10anp01</a>
<a href="#">A10 L10</a>
<a href="#">Cg150p25a</a>
<a href="#">Sgea31m06077</a>
<a href="#">Hp0653a10anp01</a>
<a href="#">Hp0394a25an Filterelement</a>
<a href="#">Cu250a25n</a>
<a href="#">8mf 030 1a25 Hb Filterelement Mit Der Drain-Filter.</a>
<a href="#">Str-140-65-G1-M250-P01 Filter</a>
<a href="#">Hp1352a10ah</a>
<a href="#">Lmp-400-3-B-A-F2-Xxx-P01</a>
<a href="#">Mph1001bosag1a25vt</a>
<a href="#">Mf1003p10nbp01 Filterelement</a>
<a href="#">Cu4006a06anp01 Return Filter</a>

<a href="#">Lva30sapm12s01 Level Indicator</a>
<a href="#">Hp 320 2a 16an Filter</a>
<a href="#">Ege5</a>
<a href="#">Fhp-135-2-B-A-F5-A25-N-P01</a>
<a href="#">Lmp-400-6-S-A-G1-Xxx-P01</a>
<a href="#">Glocke Monoblock-Lmc 140 M Fs100 4e, "mp Filtri"</a>
<a href="#">Sgeg60h03130</a>
<a href="#">8cs150m60a</a>
<a href="#">2050269</a>
<a href="#">Hp3202a03vrp01</a>
<a href="#">Hp0653a06ah</a>
<a href="#">Lmp-400-2-B-A-G2-Xxx-P01</a>
<a href="#">Mf 400 2 M60nbp01 Filter</a>
<a href="#">Fhp-135-2-S-A-G1-A25-H-P01</a>
<a href="#">Hp0652m60anp01</a>
<a href="#">Csg-050-A10-A</a>
<a href="#">Hp-135-2-A10-A-N-P01</a>
<a href="#">Lmp-400-5-B-A-G2-Xxx-P02</a>
<a href="#">Lmp-950-3-B-V-F1-A25-N-P02</a>
<a href="#">Glocke Monoblock-Lmc 140 M Fs100 4s, "mp Filtri"</a>
<a href="#">Mp90000666</a>
<a href="#">Mpa280g1m250 Filter</a>
<a href="#">Mf-100-1-P25-N-B-P01 Filterelement</a>
<a href="#">Hp5004a06anp01 High Pressure Filter</a>
<a href="#">Fhb-135-3-B-A-F1-Xxx-P01</a>
<a href="#">Sgea51?09109</a>
<a href="#">Lmp-400-2-S-A-F1-Xxx-P01</a>
<a href="#">Fhp-135-1-T-A-G2-A25-H-P01</a>
<a href="#">Mf1003p10nb Filter</a>
<a href="#">140037109 Kw 26.16</a>

<a href="#">Sgea51d05080</a>
<a href="#">Lcpg26mcbp01</a>
<a href="#">Sa185g1l40</a>
<a href="#">Dichtung Gup 004, "mp Filtri"</a>
<a href="#">Parbak 144 O-Ring63.96 X 2.18</a>
<a href="#">Mpt1002sag2a25bp01 Filter Assembly With Housing</a>
<a href="#">Bh4hc Dn 025</a>
<a href="#">Sge-A51-M10-109-Fg</a>
<a href="#">8hp0502a25anp01</a>
<a href="#">Lmp-430-5-B-A-G1-A03-N-P01</a>
<a href="#">Hp1351a10vup01 Filter</a>
<a href="#">Lmp-900-1-B-A-F3-Xxx-P01</a>
<a href="#">Lms-300-M-Fs200-4s</a>
<a href="#">Cu4006a25an Filterelement</a>
<a href="#">Hp065 2 A25 N</a>
<a href="#">Vec20aa50p01 (E1p01)</a>
<a href="#">Cu1102m25anp01 Filterelement</a>
<a href="#">Ege2 Elastisches Element</a>
<a href="#">Lmp-950-3-B-A-F3-Xxx-P01</a>
<a href="#">8hp500 4a10anp01 Filterelement</a>
<a href="#">Cu040m250n Filterelement</a>
<a href="#">Fhb-320-1-S-A-F1-Xxx-P01</a>
<a href="#">Mpf1002ag2</a>
<a href="#">Mf1003a25hb</a>
<a href="#">Hp1353a10anp01</a>
<a href="#">Fhb-135-1-S-A-F1-A10-H-P01</a>
<a href="#">Bh4hc Dn 010</a>
<a href="#">Fhp135-2-S-A-G1-M60-N-P01+n7</a>
<a href="#">Cu630m60n</a>
<a href="#">Fhp-135-2-S-A-G1-A10-H-P01</a>

<a href="#">Ege2 Ege2</a>
<a href="#">Cu350m250n Filterelement</a>
<a href="#">Sgea21fs100 Sgea21fs100</a>
<a href="#">Lmp-951-2-B-A-F2-A16-N-P01</a>
<a href="#">Hp0503p10anp01</a>
<a href="#">Lva30tapm12s01</a>
<a href="#">Sgeg40m07110 + Ege4rr + Sgeg40pd08045</a>
<a href="#">Mf0301p25nb Cartridge(Filter Hydraulik)</a>
<a href="#">Ch-070-M60a</a>
<a href="#">Fhb-065-2-B-A-F1-A25-N-P01</a>
<a href="#">Hydraulischer Filter Mp Filtri Mf 1002a 10hb</a>
<a href="#">Fhb-320-2-B-A-F1-Xxx-P01</a>
<a href="#">Lmp-430-6-B-V-G1-Xxx-P01</a>
<a href="#">Hp-135-2-A25-A-N-P01 Filterelement</a>
<a href="#">Cs-050-P25-A</a>
<a href="#">Lvk10am12t1p01</a>
<a href="#">Fhp5004baf3a10np01</a>
<a href="#">Mps050-Rg1p10a+cs0</a>
<a href="#">Ege6rr</a>
<a href="#">Glocke Monoblock-Lmc 200 M Fs100 4s, "mp Filtri"</a>
<a href="#">Mpf-030-1-A-G1-Xxx-P01 (Ex Mpf0301ac1)</a>
<a href="#">Lmp-400-4-B-A-G2-Xxx-P01</a>
<a href="#">Lmp-400-2-B-A-G1-A10-N-P01+t2</a>
<a href="#">Scs100fg1p10ap01</a>
<a href="#">Lmp-400-2-B-A-G2-M90-W-P01+t2</a>
<a href="#">Str100-3sg1-M250p01</a>
<a href="#">044014 Filterelement Hp-050-4-A16-A- N-P01</a>
<a href="#">Hp3203a10an Filterelement</a>

<a href="#">Mr-100-4-F16-F Filter</a>
<a href="#">Fhb-065-2-S-A-F1-Xxx-P01</a>
<a href="#">Mpm-030-G2-M60</a>
<a href="#">Str1401bg1m90</a>
<a href="#">Lmp-400-4-B-A-G1-Xxx-P01</a>
<a href="#">Ct150a25ab</a>
<a href="#">Fmm0503badm60np03 Filter</a> <a href="#">Druckstutzen</a>
<a href="#">Fhb3202svf1a03np01</a>
<a href="#">Sge-A51-D060-70-Fg</a>
<a href="#">Mp-S050rg1p25at</a>
<a href="#">Fhp-135-1-S-V-G5-Xxx-P01</a>
<a href="#">Hp1352a06ahp01</a>
<a href="#">Lmp-400-3-B-A-F1-Xxx-P01</a>
<a href="#">110-1-A06-A-N-P01</a>
<a href="#">Fhb-065-1-B-A-F1-A10-N-P01</a>
<a href="#">Lmp-400-2-B-A-F2-Xxx-P01</a>
<a href="#">Sa185g1l10a Filter</a>
<a href="#">Hpo 393a16a-Npo1</a>
<a href="#">Hp0502a10anp06 Filterelement</a>
<a href="#">Lena5001a1afs</a>
<a href="#">Cu100m60n</a>
<a href="#">Fhp-135-2-B-A-F2-Xxx-P01</a>
<a href="#">Sf-504-M90-N-P01 Filter</a>
<a href="#">Fhp3202sag3p01</a>
<a href="#">Mf400-2-M25-N-B</a>
<a href="#">Lmp-401-2-B-A-G1-Xxx-P01</a>
<a href="#">Mf1002a10hbp01 Filterelement</a>
<a href="#">8hp1353a10anp01</a>
<a href="#">Ch150p25a Filter</a>
<a href="#">Cu100m250n</a>

<a href="#">Sgea21fs200 Sgea21fs200</a>
<a href="#">Lmp-400-5-S-A-F2-Xxx-P01</a>
<a href="#">Lmp-951-B-A-F3-P01 Filterkopf</a>
<a href="#">Schalter Manometer Em1-Ag A P01, "mp Filtri"</a>
<a href="#">Ta80 B 10 A 000 P01 Filter</a>
<a href="#">Mf1801a25hb Hydraulic Cartridge(Filters)</a>
<a href="#">Lmp-900-2-S-A-F1-Xxx-P01</a>
<a href="#">Sa185g1l10a Verschnaufpause In Der Sammlung</a>
<a href="#">Lmp-400-3-B-A-G1-Xxx-P01</a>
<a href="#">Lmp-400-5-B-A-F1-Xxx-P01</a>
<a href="#">Mf0301m25nb Filterelement</a>
<a href="#">Cs050m90a Filter</a>
<a href="#">Cu040m90n Filterelement</a>
<a href="#">Lmp-430-6-B-A-F1-A06-N-P01</a>
<a href="#">Sgea21m05055 Sgea21m05055</a>
<a href="#">Fhb-065-1-B-A-F1-A03-N-P01</a>
<a href="#">Mpf-400-2-Ag-2</a>
<a href="#">Bva14p01</a>
<a href="#">01zag 26 C4 01 D 01zag C4 26 01 D</a>
<a href="#">Hp0392a10anp01</a>
<a href="#">Sgea21fs100</a>
<a href="#">Sgea21m04048 Sgea21m04048</a>
<a href="#">Lmp-400-6-S-A-F2-Xxx-P01</a>
<a href="#">Fhb-065-3-S-A-F1-Xxx-P01</a>
<a href="#">Hp0111a25ahp01</a>
<a href="#">Mr 250 1 A10 A P01 Filter</a>
<a href="#">Mpa180g1m90</a>
<a href="#">02zag 08 Co 34 D</a>
<a href="#">Lmp-900-1-S-A-F3-Xxx-P01</a>



<a href="#">Fhp-135-2-S-A-G2-Xxx-P01</a>
<a href="#">Fhb-050-4-S-V-F1-Xxx-P01</a>
<a href="#">Str0861bg1m60p01</a>
<a href="#">Mf4002p10nb Filterelement</a>
<a href="#">110 1 A06 A N P01</a>
<a href="#">Hp3202a10ahp01</a>
<a href="#">Fmp3203bag1a25n Filter Hochdruck</a>
<a href="#">Hp0371m60an</a>
<a href="#">Hp1352a03np01</a>
<a href="#">Fhp1352bg2a10np01+dea50ha50p01 Pressure Filter With Indicator.</a>
<a href="#">Mf1002a10hb Filterelement</a>
<a href="#">Hp 0201 A03ah</a>
<a href="#">Sgea31m06077fg</a>
<a href="#">Dp090a020anp01 Filterelement</a>
<a href="#">Lena1501a1afs</a>
<a href="#">Str-140-4-B-G1-M90-P01</a>
<a href="#">Cu040 M25 N</a>
<a href="#">Lmc350afsu080</a>
<a href="#">Hp3204m25anp01 Filterelement</a>
<a href="#">016009 Filter G1m90 Str-050-1-S-G1- M90-P01</a>
<a href="#">Hp1351a03vup01 Filter</a>
<a href="#">Mr2504 Filter-Element</a>
<a href="#">Str1003bg1m900p01 Filter</a>
<a href="#">Filter Druckstutzen Fmp 135 1 A B G1 P01, "mp Filtri"</a>
<a href="#">Mf 1002a10hbp01 Filterelement</a>
<a href="#">Mf0301p25nb</a>
<a href="#">Hp 0201 A03ah Filter</a>
<a href="#">Fhp-135-2-B-A-G1-A06-N-P01</a>

<a href="#">Mpf 030 1 Ag1a25hbp01 + Fx15rm3 25</a>	
<a href="#">???. Filter Drain</a>	
<a href="#">Sgea31fs200</a>	
<a href="#">Mf 0301p10nbp01 Filter</a>	
<a href="#">Fhp-135-2-S-A-G1-Xxx-P01</a>	
<a href="#">Mps050-Rg1p10a C</a>	
<a href="#">Cu2101m25anp01 Filterelement</a>	
<a href="#">Lms-250-A-Fra-070</a>	
<a href="#">Hp1353a10an Filterelement</a>	
<a href="#">Mf1002p25nbp01</a>	
<a href="#">Fri630saf1</a>	
<a href="#">Filter Mf1002a25hbp01</a>	
<a href="#">2050272</a>	
<a href="#">Lcpg60ncas</a>	
<a href="#">Cs150a10a Filter-Element</a>	
<a href="#">Luftfilter-Sapun C Tankdeckel Hals Ta80</a>	
<a href="#">B 10 A 1 L 2 Po1</a>	
<a href="#">Fhp0651bag2a10ns</a>	
<a href="#">20472</a>	
<a href="#">Mf4002p25nb</a>	
<a href="#">??80?10?002p01</a>	
<a href="#">Lmp-400-3-S-A-G2-Xxx-P01</a>	
<a href="#">Mf-750-1-P10-N-B-P01</a>	
<a href="#">Mf4003a10hbp01 Filter</a>	
<a href="#">Ege-8</a>	
<a href="#">Mpf1002ag3p10nbt</a>	
<a href="#">Lmp-430-6-B-A-G1-Xxx-P01</a>	
<a href="#">Cs-050-P10-A</a>	
<a href="#">Hp0652a10ahp01</a>	
<a href="#">Taf80b10a0l1mp01</a>	
<a href="#">Dle20va50p01</a>	DLE20VA50P01 OPT./ELEKT. 2.0 BAR old name: E6
<a href="#">Akam11-P-0242</a>	

<a href="#">Sf-503-M25 Filterelement</a>
<a href="#">Cu2102m60anp01</a>
<a href="#">Hp0653m60n</a>
<a href="#">Lmp-900-1-B-A-F1-Xxx-P01</a>
<a href="#">Mf1801a10hb Filterelement</a>
<a href="#">Lmp-400-6-B-A-F2-Xxx-P01</a>
<a href="#">Sa075 G2 L40a Cbb.21b06.Cd 3/4 Hydraulikfilter (Mmc 80)</a>
<a href="#">Lmp-900-1-B-A-F3-M90-N-P01+t2</a>
<a href="#">Hp0392a06anp01</a>
<a href="#">Hp0392a25an Filter</a>
<a href="#">Str0451sg1m250p01</a>
<a href="#">Fhb-135-2-B-A-F1-A10-N-P01</a>
<a href="#">Hp0371m25an</a>
<a href="#">720008</a>
<a href="#">Hp0502a06anp01</a>
<a href="#">024123 Filterelement Cu-630-A10-N</a>
<a href="#">Fmp 038-2-B-Ag1-A25n/S Hydraulikfilter (Mmc 80)</a>
<a href="#">Lmp-400-2-S-A-G1-A06-N-P01+t2</a>
<a href="#">Mf0301p10nbp01</a>
<a href="#">Hp0502a10anp06 Filter</a>
<a href="#">Cu4005a10an</a>
<a href="#">Cs-100-A10-A Filter-Element</a>
<a href="#">Fhp-135-1-S-V-G1-Xxx-P01</a>
<a href="#">Fzp-039-3-Bab Filter Druckpumpe (Cartridge)</a>
<a href="#">Cu250m25n</a>
<a href="#">8h? 0502a10an Filterelement</a>
<a href="#">Gum-P-250</a>
<a href="#">Cu2102a06anp01</a>
<a href="#">019155 Filterelementmf-100-2-A10-H-B-</a>

<a href="#">P01</a>
<a href="#">Sgea21a21fs200</a>
<a href="#">Lmp-400-2-S-A-G1-A10-N-P01+t2</a>
<a href="#">Fhb-135-2-S-A-F1-Xxx-P01</a>
<a href="#">Dva20hp01</a>
<a href="#">Lena3501a1agsp01 Oelstandssensor</a>
<a href="#">Sgea2100048 Sgea2100048</a>
<a href="#">Lmp-900-1-B-A-F1-A25-N-P01+t2</a>
<a href="#">Mf1802p10nb Filterelement</a>
<a href="#">Cu-250-M25-N</a>
<a href="#">Hp0502a25anp01</a>
<a href="#">Str1003sg1m90p01</a>
<a href="#">Fhp-135-2-B-A-F5-Xxx-P01</a>
<a href="#">Str 0502 B G1m90p01</a>
<a href="#">Mf1801a10hbep01 Filtroelement</a>
<a href="#">Hp-320-4-A10-V-H</a>
<a href="#">Hp3203a06ahp01 Filterelement</a>
<a href="#">8ch150p25a</a>
<a href="#">Hp0113a10ah Filter</a>
<a href="#">Lmp-400-3-S-A-F1-Xxx-P01</a>
<a href="#">Lmp-400-6-B-A-G2-Xxx-P01</a>
<a href="#">Lva 30 Sapm12s02</a>
<a href="#">Mf4002a25h</a>
<a href="#">Fri-040-B-A-G1-M25-N-Vg</a>
<a href="#">Fri100bag1p10</a>
<a href="#">Lmp-430-6-B-A-F2-A10-N-P01</a>
<a href="#">Filter Mp Filtri Mps100sg1250a</a>
<a href="#">Mr1003a25a</a>
<a href="#">Ege0</a>
<a href="#">J7</a>
<a href="#">Cu4003a06anp01 Purge/Case Drain</a>

<a href="#">Filter</a>
<a href="#">Lmp-400-4-B-A-F2-Xxx-P01</a>
<a href="#">065 2-?10</a>
<a href="#">Ri-2121</a>
<a href="#">Cu9503a10anp01</a>
<a href="#">Fmp-065-1-B-A-G1-M60-N-P01+n7</a>
<a href="#">Fhb-135-1-S-V-F1-Xxx-P01</a>
<a href="#">Hp0502a25anp01 Filterelement</a>
<a href="#">Filterelement Mp Filtri Hp 0372 M25 Anp01 (Hf0372)</a>
<a href="#">Mf0301a10hb</a>
<a href="#">Str-140-2s-G1-M250-P01 Filter</a>
<a href="#">Mf7501a10hbp01</a>
<a href="#">Icm 2.0</a>
<a href="#">Hp0503a25anp01</a>
<a href="#">Lmp-400-3-B-V-G2-A25-N-P01</a>
<a href="#">Fhb-135-2-S-A-F1-A10-H-P01</a>
<a href="#">Lms-250-A-Fsb-060</a>
<a href="#">Filterelement Ch150p25a</a>
<a href="#">Filter Mp Filtri Mf1002a25hb</a>
<a href="#">Lmp-400-2-S-A-G1-A25-N-P01+t2</a>
<a href="#">Fhp-135-2-S-A-G2-A10-H-P01</a>
<a href="#">Dichtung Gup P002, "mp Filtri"</a>
<a href="#">Mpf1842af1a16hep01 + Bla20ha51p01</a>
<a href="#">Sgea21m05055fg</a>
<a href="#">Lmp-210-B-G2-Kopf</a>
<a href="#">Mf1003p10nb</a>
<a href="#">Ch 050-P25-A</a>
<a href="#">Hp0502a16anp01 Filter Element</a>
<a href="#">Fhb-135-1-S-A-F1-Xxx-P01</a>
<a href="#">Lmp-900-2-B-A-F3-Xxx-P01</a>

<a href="#">Lmp-430-5-B-V-G1-A25-N-P01</a>
<a href="#">Hp1352a10anp01</a>
<a href="#">Cu250a10n</a>
<a href="#">Sm13g50a</a>
<a href="#">Vea_21aa50p01 Indicator T-021 Barmfg-04/1:5250 Vac-5a</a>
<a href="#">Lmp-401-3-B-A-G1-Xxx-P01</a>
<a href="#">Lmp-900-2-B-A-F3-A10-N-P01+t2</a>
<a href="#">8mf1002a10hbp01</a>
<a href="#">Cu-630-A10-V</a>
<a href="#">Cu100a06n</a>
<a href="#">Lmg201mfs2004s C2/19 Glocke</a>
<a href="#">Hp3203a10ah</a>
<a href="#">Lmp-400-2-S-V-G1-Xxx-P01</a>
<a href="#">Fhb-135-1-B-A-F1-A10-N-P01</a>
<a href="#">Filter Hp0502a10anp06</a>
<a href="#">Hp0503m60anp0</a>
<a href="#">Lmp-950-2-B-A-F1-Xxx-P01</a>
<a href="#">Ege3</a>
<a href="#">Lms-300-A-Fsd-070</a>
<a href="#">Cu630m250</a>
<a href="#">Sge-A21-Fs1m0</a>
<a href="#">Sgea01m01021</a>
<a href="#">8mf1801a25hbp01</a>
<a href="#">Lmc 350 A Fsu 070 Glocke Einteilig</a>
<a href="#">Sgea31?0342</a>
<a href="#">Cs 050 P25 A Filterelement</a>
<a href="#">Lmp-400-6-S-A-G2-Xxx-P01</a>
<a href="#">Sf504m25 Filterelement</a>
<a href="#">Cs100p10a</a>
<a href="#">Filter Mpt0251sag2a25ep01 Indikator C Fx15</a>

<a href="#">Mf4003a25hb</a>
<a href="#">Emi-B-Ci-A-Poi</a>
<a href="#">RI-G2-N-F3-S1a-S1-500 (Ex. Len-A-350-2-A-1-A-F-S)</a>
<a href="#">Ufm041ta1010p01</a>
<a href="#">Fhp-135-1-S-V-G2-Xxx-P01</a>
<a href="#">Ho0652a10ha</a>
<a href="#">Fhb-320-1-B-A-F1-Xxx-P01</a>
<a href="#">Filterelementhp-135-3-A10-A-N-P01</a>
<a href="#">Cg150a10a</a>
<a href="#">Fmp1352bag2m10np01</a>
<a href="#">Mf1801p25nbp01</a>
<a href="#">Ege5rr</a>
<a href="#">Cs150m90a</a>
<a href="#">Mr-630-5-A10-A</a>
<a href="#">Cu250250v Filter Element</a>
<a href="#">Filter Fha0511baca25np01 C Indikator EZ</a>
<a href="#">Mr2504a10a Filter</a>
<a href="#">Mf1002?25hbp01 Filterelement</a>
<a href="#">Filter Hp0392f10anp01</a>
<a href="#">Mpf0301ag1a06hep01</a>
<a href="#">Fx15 125vac-3a/110vdc-0,15a Anzeige Einer Verunreinigung Des Filters</a>
<a href="#">Mf1801m25nbp01 Filtroelement</a>
<a href="#">Fhp-135-2-B-A-G6-Xxx-P01</a>
<a href="#">Sf-503-?250-P01 Filter</a>
<a href="#">Cu025m90n Filter</a>
<a href="#">Dva50hp01</a>
<a href="#">Fmp 065-2-S-Ag1-A25n/S Hydraulikfilter (Mmc 80)</a>
<a href="#">Lmp-400-5-B-A-G1-Xxx-P01</a>

<a href="#">Lmp-900-1-B-A-F1-A03-N-P01+t2</a>	
<a href="#">Mf1801a25hb</a>	
<a href="#">Fhp3202saf4m60nj</a>	FILTER
<a href="#">2p 2barp</a>	
<a href="#">Mf1003a10hb</a>	
<a href="#">Fmm0502baca10np01 Filter Warmbrauchwasser Mit Visa.Indikator</a>	
<a href="#">Elastischer Element Ege 0 Rp Gs, "mp Filtri"</a>	
<a href="#">Filtroelement Cu350m60n</a>	
<a href="#">Fhp-135-2-B-V-G1-Xxx-P01</a>	
<a href="#">Lmp-400-3-S-A-F2-Xxx-P01</a>	
<a href="#">Dp120a020anp01 Filterelement</a>	
<a href="#">Fhb-135-2-B-A-F1-Xxx-P01</a>	
<a href="#">1007.708</a>	
<a href="#">Fhb-065-3-B-A-F1-Xxx-P01</a>	
<a href="#">Fhp-135-1-T-A-G2-P01</a>	
<a href="#">Sml1map01 The Filler Neck.</a>	
<a href="#">Lvu1500pa10p01</a>	
<a href="#">Emi-Cga.Poi</a>	
<a href="#">Fhp-135-2-B-A-G1-A10-N-P01</a>	
<a href="#">Cu350m60n Filterelement</a>	
<a href="#">8cu2101m60anp01</a>	CU2101M60ANP01 Filterelement
<a href="#">049k49201p100ho</a>	
<a href="#">Sgea21m03048fg</a>	
<a href="#">Fhb-135-3-S-A-F1-Xxx-P01</a>	
<a href="#">Ege-2</a>	
<a href="#">Filtermf4003p25nbp01</a>	
<a href="#">Lmp-951-2-B-A-F2-Xxx-P01</a>	
<a href="#">Str1001bg1m90p01</a>	
<a href="#">Hp0372a10an</a>	



<a href="#">Str 100-2bg1m60 Filterelement</a>
<a href="#">Fhp5004baf3a10np01 + Dla50ha51p01</a> <a href="#">Druckfilter</a>
<a href="#">Fhp1353bg2a10np01+dea50ha50p01</a> <a href="#">Pressure Filter With Indicator.</a>
<a href="#">Dea50ha50p01</a>
<a href="#">E7-5bar</a>
<a href="#">Str0502bg1m90 Filterelement</a>
<a href="#">Msh-050-B-A-G3-M90-V6</a>
<a href="#">Fhp1353bg2a06np01+dea50ha50p01</a> <a href="#">Pressure Filter With Indicator.</a>
<a href="#">Str 070/4 Filter Saugseite Der Pumpe</a> <a href="#">(Cartridge)</a>
<a href="#">Mpf1002ag2a25hb Filterelement</a>
<a href="#">Ta80b03a001p01</a>
<a href="#">Fhp-135-2-S-A-F5-Xxx-P01</a>
<a href="#">Hp0502a10anp01 Filterelement</a>
<a href="#">Hp5003500asp01</a>
<a href="#">044009 Druckfilter Fmm-050-4-B-A-D-</a> <a href="#">Xxx-P01</a>
<a href="#">Lmp-400-3-B-A-G2-Xxx-P01</a>
<a href="#">Hp0653a25anp01</a>
<a href="#">Mf1801a25hb Cartridge(Filter Hydraulik)</a>
<a href="#">Lmc-250-M-Fs200-4e</a>
<a href="#">A11-L10-A</a>
<a href="#">Lmp-400-4-B-A-G1-M25-N-P01+t2</a>
<a href="#">Hp1352a25an</a>
<a href="#">Lmp-900-2-B-A-F1-A10-N-P01+t2</a>
<a href="#">Mpi6304cdaa10p01</a>
<a href="#">Filer Mps100sg1m90a</a>
<a href="#">Ch-050-M90-A</a>
<a href="#">Rts 18/40</a>
<a href="#">Mfi002p025nbp01</a>

<a href="#">Sf503m60 Filterelement</a>
<a href="#">Hp3202250an</a>
<a href="#">Lmp-950-3-B-A-F3-A10-N-P01</a>
<a href="#">Bea15ha50p01</a>
<a href="#">Stutzen Te25a250</a>
<a href="#">Ta80b10b002p01</a>
<a href="#">Lmp-400-2-B-A-G1-Xxx-P01</a>
<a href="#">Mf-180-1-A-A-10-H-B</a>
<a href="#">Fhb-320-2-B-A-F1-A10-N-P01</a>
<a href="#">Hp0394a06anp01</a>
<a href="#">Mr6304a10a Filter-Element</a>
<a href="#">016170 Saugkorb Str-065-4-B-G1-M250-P01</a> Lieferzeit 6-7 Wochen
<a href="#">Mph1165cdsag2a25p01+bea14ha50p01</a> Drain Filter With Indicator.
<a href="#">Bs-Lpa-M-110-Eu</a>
<a href="#">Lmp-400-3-B-A-G1-A06-N-P01+t2</a>
<a href="#">Schalter Manometer Em1-C G A P01</a>
<a href="#">Cs100p10a Filteralternative Nummer:</a> <a href="#">Mpf574864</a>
<a href="#">Fmp-038-1-Fa-G1-P01</a>
<a href="#">Sgea31fs300</a>
<a href="#">Lmp-401-4-B-A-F2-Xxx-P01</a>
<a href="#">Lmp-210-3-S-V-G3-Xxx-P01</a>
<a href="#">Hp 135 2 A10 A N P01 Filter</a>
<a href="#">10860 Fri025bag1a25n</a>
<a href="#">Mf 030 1 M25 Nb</a>
<a href="#">Str 050 2 B G1 M90p01</a>
<a href="#">Mp Filtri Tipo Hp037</a>
<a href="#">A11110</a>
<a href="#">Fhb-065-1-B-A-F1-Xxx-P01</a>
<a href="#">Mpm-300-G1-M90</a>

<a href="#">Mf-030-1-A10-Hb</a>
<a href="#">Hp3202a25vnp01 Saug-Filterelement</a> <a href="#">Hp3202a025vnp01</a>
<a href="#">Str 140 4sg1 M250p01 Filter</a>
<a href="#">Hp3204a25anp01 Filter-Element</a>
<a href="#">Lmc-250-M-Fs1mo-4s</a>
<a href="#">Str0704bg1m90p01</a>
<a href="#">Fhb-320-2-B-A-F1-A06-N-P01</a>
<a href="#">Fhb-065-3-B-A-F1-A10-N-P01</a>
<a href="#">Lmc250mfs2004e Lmc250mfs2004e</a>
<a href="#">Lmp-400-2-S-A-F2-Xxx-P01</a>
<a href="#">Fhb-065-1-B-A-F1-A06-N-P01</a>
<a href="#">Sp-Cfe 250/125</a>
<a href="#">Cs-100-A25-A</a>
<a href="#">Hp3202a10anp01 Filter-Element</a>
<a href="#">Fri-100-B-A-G1-M25-N-T2</a>
<a href="#">Ege4</a>
<a href="#">Cs100p25a</a>
<a href="#">Cu630m25n</a>
<a href="#">Lmp-430-5-B-A-F2-Xxx-P01</a>
<a href="#">Hp1352a10an</a>
<a href="#">Lmp-400-6-S-A-F1-Xxx-P01</a>
<a href="#">Esa.11b04.W.M.F 050/2 S M090 G1 1/2</a> <a href="#">Hydraulikfilter (Mmc 80)</a>
<a href="#">Hp 065 3 M60 An</a>
<a href="#">Dichtung Gum P 140, "mp Filtri"</a>
<a href="#">016033 Saugkorb Str-070-3-S-G1-M90-P01</a>
<a href="#">8mr6305a10ap01</a>
<a href="#">Cu850a10n Filterelement</a>
<a href="#">Cu630m250cf Filter Element</a>
<a href="#">Cu1102m90hnp01 Filterelement</a>

<a href="#">Sa145g1l03a</a>	
<a href="#">Hp0503a10anp01</a>	
<a href="#">Hp 3203a25vnp01 Filterelement</a>	
<a href="#">Mpf-180-1-A-G1-A10-H-B-Er</a>	
<a href="#">Hp3202a10ha</a>	
<a href="#">Mf180 1 A10 Hb E P01</a>	
<a href="#">Cu025m60n</a>	
<a href="#">Sgeg60g060502g</a>	
<a href="#">Lms400afsh070</a>	
<a href="#">Cu1101m25anp01 Filter</a>	
<a href="#">Cs150a10a Filterelement</a>	
<a href="#">Sa075 G1 L40a Cbb.21b04.Cd 1/2 Hydraulikfilter (At 127)</a>	
<a href="#">Mpa-150-M250-Ag Filter</a>	
<a href="#">Lvk30am122t7p01+tv12</a>	
<a href="#">Hp1351a25ahp01 Filterelement</a>	
<a href="#">Mf1801a25hbp01 Filter Element</a>	
<a href="#">Sf503m90np01 Filterelement</a>	
<a href="#">2086</a>	
<a href="#">Lmp-400-5-B-A-G1-A03-N-P01</a>	
<a href="#">Lmp-430-5-B-A-G1-A06-N-P01</a>	
<a href="#">Hp320 2 A25 An</a>	
<a href="#">Elastischer Element Ege 2 Rp Gs, "mp Filtri"</a>	
<a href="#">Cs-150-M60-A Filter-Element</a>	
<a href="#">Lmp-430-6-B-V-G1-A10-V-P01</a>	
<a href="#">Bea20ha50p01</a>	FE20H1AP01 und FX20R2M3
<a href="#">Mf-400-2-A10-H-B Filter</a>	
<a href="#">75034542</a>	
<a href="#">Lms-300-A-Fsd-060</a>	
<a href="#">Ho 020 1 A01 Ah</a>	

<a href="#">Mf0301a16hbep01 Filter Element</a>
<a href="#">8cs050m90a Filter Cs050m90a</a>
<a href="#">Sge-A21-Fs200</a>
<a href="#">Hp0503m60anp01</a>
<a href="#">Fmm0503bada10np03</a>
<a href="#">Sa185g1l03a Luftfilter</a>
<a href="#">0160 R 025 W</a>
<a href="#">Fzp1361sva6a10up01 Filter</a>
<a href="#">Mpf1002ag3p01</a>
<a href="#">Lmp-400-6-B-A-F1-Xxx-P01</a>
<a href="#">Hp3204a25an Der Backbone- Filter/Element</a>
<a href="#">Str 070-4bg1m60 Filterelement</a>
<a href="#">Mf0301a25hbp01</a>
<a href="#">Filterelement Hp-135 1a 10 N P01, "mp Filtri"</a>
<a href="#">Mfi002p010nbp01</a>
<a href="#">Lmp-400-5-B-A-F1-A10-N-P01+t2</a>
<a href="#">Filtroelement Cu350m250n</a>
<a href="#">Lva30tapm12s01 Level And Temperature Indicator.</a>
<a href="#">Fhb-065-1-B-A-F1-A10-N-P03</a>
<a href="#">Hp0504a25an Filter</a>
<a href="#">Mpf1002p25nbp01 Filterelement (Papier, 25 Mikron)</a>
<a href="#">Lmp-950-2-B-A-F1-A10-N-P01</a>
<a href="#">Lmp-951-3-B-A-F1-Xxx-P01</a>
<a href="#">Or 3256 O-Ring64.77 X 2.62</a>
<a href="#">Lms-250-A-Fsa-060</a>
<a href="#">Fmm0505bada10np01</a>
<a href="#">Lmp-950-3-B-A-F1-Xxx-P01</a>
<a href="#">Hp-320-1-A10-V-H</a>

<a href="#">Lmp-950-2-B-A-F1-A06-N-P01</a>
<a href="#">Fmp3204bag4m25np01 Filter</a> <a href="#">Druckstutzen</a>
<a href="#">Mf4003a25hb Return Filter Cartridge</a>
<a href="#">Mf100 3a 25h Bp01</a>
<a href="#">Gup-P-004</a>
<a href="#">01 15 025</a>
<a href="#">Mph6302cdsaf2a25p01+bea14ha50p01</a> <a href="#">Drain Filter With Indicator.</a>
<a href="#">Fhb-065-3-B-A-F1-A25-N-P01</a>
<a href="#">Hp0652a03anp01 Filterelement</a>
<a href="#">Sgea21m02024fg</a>
<a href="#">Fhb-320-1-B-A-F1-A10-N-P01</a>
<a href="#">Sf503m25 Filter</a>
<a href="#">Fhp-135-2-B-V-G5-Xxx-P01</a>
<a href="#">PI0701a003ahp01 Filter</a>
<a href="#">Ch150a25a</a>
<a href="#">Mf1801a10hbp01 Filterelement</a>
<a href="#">Fhp-135-2-B-V-G2-Xxx-P01</a>
<a href="#">Lmp-400-5-B-V-F1-Xxx-P01</a>
<a href="#">Fhp-135-2-S-A-F1-Xxx-P01</a>
<a href="#">Akmmo-3p0214</a>
<a href="#">Lms-250-A-Fsa-042</a>
<a href="#">Str0702s</a>
<a href="#">Lmp-900-2-B-A-F1-Xxx-P01</a>
<a href="#">Cs-100-P10-A</a>